

Low Voltage Limiter Non-Time-Delay

ANL

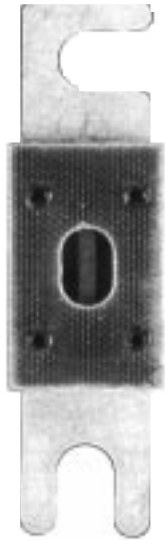

Dimensional Data

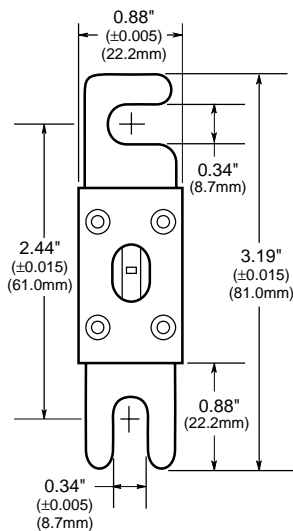

Time-Current Characteristic Curves—Average Melt

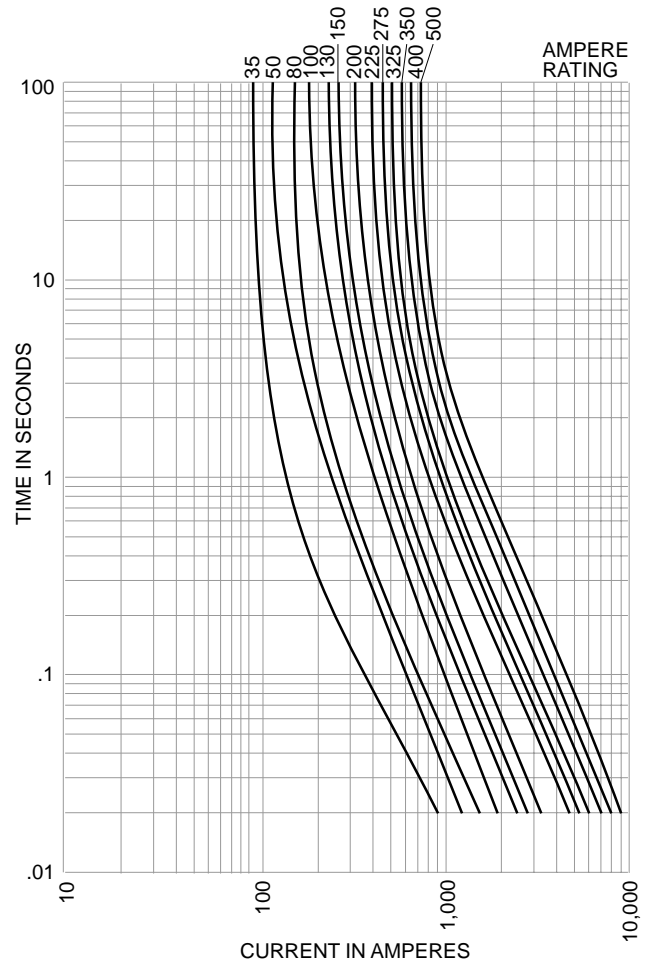

CATALOG SYMBOL: ANL
NON-TIME DELAY
32 VOLTS AC
35 TO 750 AMPERES
U.L. RECOGNIZED
(600, 675 AND 750 AMPS ONLY)
(GUIDE # JFHR2, FILE # E56412)
INTERRUPTING RATING: 6000 AIC

Electrical Ratings (Catalog Symbol and Amperes)

32 Volts AC IR 6000A		32 Volts AC IR 2700A	
ANL-35	ANL-130	ANL-275	ANL-600
ANL-40	ANL-150	ANL-300	ANL-675
ANL-50	ANL-175	ANL-325	ANL-750
ANL-60	ANL-200	ANL-350	—
ANL-80	ANL-225	ANL-400	—
ANL-100	ANL-250	ANL-500	—
ANL-125	—	—	—

**Type ANL Low Voltage Limiters
Non-Time-Delay**

- Isolates faults in equipment systems such as lifttrucks and other battery operated systems.
- Silver-plated copper link.
- Link element visible thru mica window.

Recommended Fuseblock: No. 4164

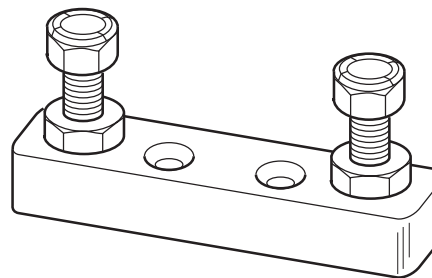

This bulletin is intended to clearly present comprehensive product data and provide technical information that will help the end user with design applications. Bussmann reserves the right, without notice, to change design or construction of any products and to discontinue or limit distribution of any products. Bussmann also reserves the right to change or update, without notice, any technical information contained in this bulletin. Once a product has been selected, it should be tested by the user in all possible applications.